

Pearisburg

315
325
335
345

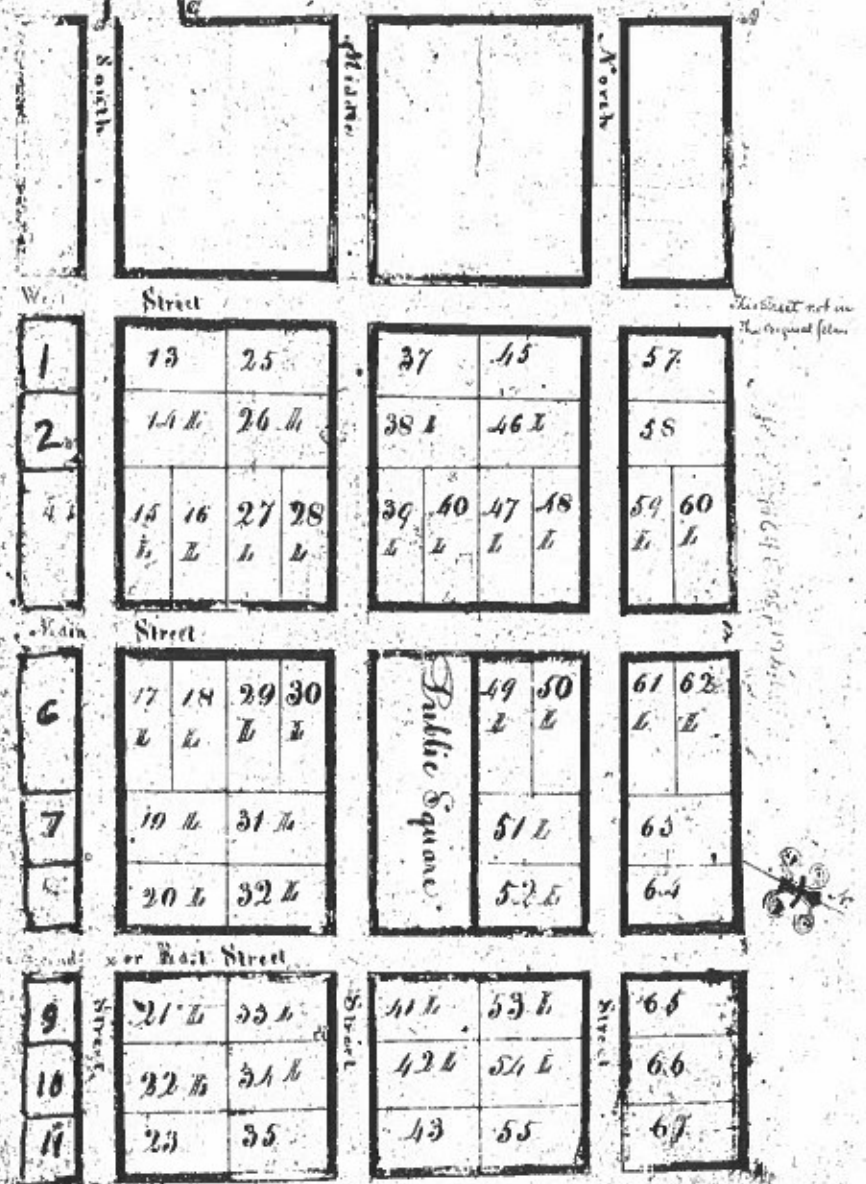

$\frac{E}{298}$

The Ordinance in and order from the County Court of Giles
 passed at the March Term 1809. I recd on the 10th day
 of Pearisburg donated by the late Col. George Pearis with
 respect to the purchase of said land for the benefit of the same
 as by the said Ordinance. I have thereon the original
 of the said Ordinance for the County.